

# COLONY COVE

A TRACT OF LAND SITUATED IN LOT 1 OF SECTION 2, TOWNSHIP 23 NORTH, RANGE 21 EAST OF THE INDIAN BASE AND MERIDIAN IN MAYES COUNTY, OKLAHOMA.

SURVEYOR:  
Green Country Surveying  
301 East Graham Avenue  
P.O. Box 445  
Pryor Creek, Oklahoma 74362  
Phone: (918) 825-6575  
C.A. No. 2425

ENGINEER:  
DeShazo, Tang & Associates, Inc.  
Towne Centre Office Park  
10830 East 45th, Suite 204  
Tulsa, Oklahoma 74146  
Phone: (918) 627-0046  
C.A. No. 1297

## LOCATION MAP

SCALE: 1"=2000'

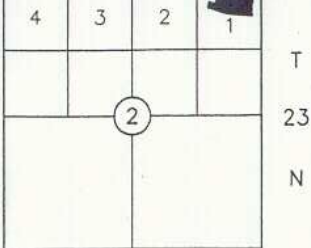

E-W SECTION LINE  
506.25'  
S 89°43'23" E

POINT OF BEGINNING - TRACT A

S 89°43'23" E  
583.75'

16.5' STATUTORY R/W

NW CORNER  
LOT 1, SECTION 2,  
T-23-N, R-21-E



0 50 100 200

MAYES COUNTY, OKLAHOMA  
BASIS OF BEARING  
NORTH LINE OF  
SECTION 2, TOWNSHIP 23  
NORTH, RANGE 21 EAST

UNPLATTED

UNPLATTED

POINT OF BEGINNING - TRACT B

S 73°13'44" E  
21.04'  
N 13°17'18" E  
102.20'  
S 69°49'08" E  
100.11'  
S' U/E

N 28°04'17" E  
284.27' E

5' U/E (TYP.)

TRACT A

5' U/E (TYP.)

POOL AREA

16.77'  
S 88°31'59" W

100.44'  
S 00°06'37" W

225.74'  
S 01°34'08" E

35.77'  
N 72°57'00" W  
G.R.D.A. TAKING LINE

311.00'  
N 71°18'00" W

GRAND LAKE O THE CHEROKEES

119.63'  
N 76°15'28" W

TRACT B  
MARINA EASEMENT PARCEL

G.R.D.A. TAKING LINE

28.05'

## LEGEND

